





# Wilmslow Crescent, Thelwall, Warrington, WA4 2JE

£275,000

🛏️ 2 🪑 1 🚗 2

- Two Double Bedrooms
- Spacious Throughout
- Driveway & Garage
- Viewing Advised
- Freehold Tenure
- Semi-Detached Bungalow
- Popular Location
- Gardens to Front & Rear
- No Onward Chain Delay
- EPC: TBC. Council Tax:C.



**RECENTLY REFURBISHED, TWO BEDROOM SEMI-DETACHED BUNGALOW. NO ONWARD CHAIN DELAY. POPULAR RESIDENTIAL AREA. VIEWING ADVISED.**







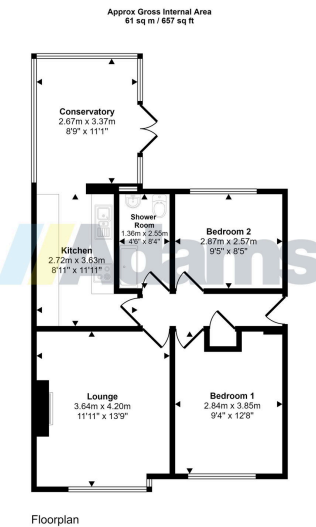

This floorplan is only for illustrative purposes and is not to scale. Measurements of rooms, doors, windows, and any items are approximate and no responsibility is taken for any error, omission or mis-statement. Items of furniture such as bathroom suites are representations only and may not look like the real items. Made with Made Shabby 300.



Energy Efficiency Rating		
	Current	Potential
Very energy efficient - lower running costs		
(92 plus) <b>A</b>		
(81-91) <b>B</b>		
(69-80) <b>C</b>		77
(55-68) <b>D</b>	61	
(39-54) <b>E</b>		
(21-38) <b>F</b>		
(1-20) <b>G</b>		
Not energy efficient - higher running costs		
<b>England &amp; Wales</b>	EU Directive 2002/91/EC	

[www.adamsea.co.uk](http://www.adamsea.co.uk)

**RUNCORN**

54 High Street, Runcorn, WA7 1AW  
01928 574401  
runcorn.sales@adamsea.co.uk

**STOCKTON HEATH**

12-14 Walton Road, Stockton Heath, WA4 6NL  
01925 398343  
s.heath@adamsea.co.uk

**WIDNES**

53-55 Albert Road, Widnes, WA8 6JS  
0151 420 4055  
widnes.sales@adamsea.co.uk

Adams is a trading name of Adams Sales Ltd.  
Registered office 53 Albert Road, Widnes, WA8 6JS.  
VAT Registration No. 582 2476 27. Registered in England No. 05232172