



Bridgewater Close, Frodsham WA6 7GY

£135,000

🛏️ 2 🪑 2 🚗 1



TWO BEDROOM FIRST FLOOR APARTMENT. WELL PRESENTED THROUGHOUT. SOUGHT AFTER AREA. NO CHAIN DELAY.

Adams Estate Agents are delighted to market this TWO bedroom first floor apartment in the popular residential area of Frodsham, situated within close proximity of commuter links and all local amenities, the property also benefits from allocated parking. In brief, the apartment comprises of entrance hall, lounge and kitchen, two bedrooms with an en-suite to the main bedroom. Externally, there is allocated parking and communal gardens. EPC Rating C. Council Tax Band B. Viewing advised to appreciate what is to offer.

Viewing

By prior appointment through our Stockton Heath office on 01925-398343.

Notes

All measurements are approximate. No appliances or central heating systems referred to within these particulars have been tested and therefore their working order cannot be verified. Floor plans are for guide purposes only and all dimensions are approximate.

Agent Notes

Tenure: Leasehold.

Lease Details: TBC.



Approx Gross Internal Area
58 sq m / 629 sq ft

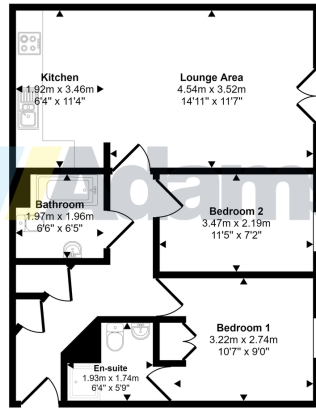

Floorplan

This floorplan is only for illustrative purposes and is not to scale. Measurements of rooms, doors, windows, and any items are approximate and no responsibility is taken for any error, omission or mis-statement. Icons of items such as bathroom suites are representations only and may not look like the real items. Made with Made Snappy 360.

- First Floor Apartment
- En Suite To Master
- Fantastic Location
- Council Tax B
- No Onward Chain
- Two Bedrooms
- Allocated Parking
- EPC Rating C
- Viewing Advised

