



Gainsborough Road, WA4 6DA

Offers In Region Of £270,000

2 1 3



TWO BEDROOM SEMI-DETACHED DORMER BUNGALOW. WELL PRESENTED THROUGHOUT. NO ONWARD CHAIN DELAY. VIEWING ADVISED.

Adams Estate Agents are delighted to offer to the market this well presented two bedroom semi-detached bungalow, located on the ever popular Gainsborough Road. The property has been very well cared for over recent years, making this the ideal home to move straight in to. In brief, the spacious accommodation comprises; entrance hall, large open plan lounge/dining area, kitchen, conservatory, bedroom and bathroom to the ground floor. To the first floor, there is a spacious landing with ample storage and further bedroom. Externally, to the front of the property, there is driveway parking for several cars, which provides access to the garage. To the rear, there is a good size garden, enclosed with a brick built wall.

Internal inspection is advised to fully appreciate what is to offer.

Viewing

By prior appointment through our Stockton Heath office on 01925-398343.

Notes

All measurements are approximate. No appliances or central heating systems referred to within these particulars have been tested and therefore their working order cannot be verified. Floor plans are for guide purposes only and all dimensions are approximate.

Agent Notes

Tenure: Freehold

Council Tax Band: C

Local Authority: Warrington Borough Council



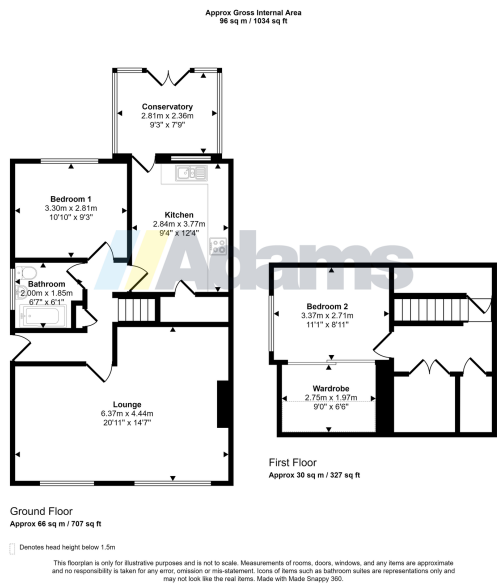

- Two Bedroom
- Semi-Detached Bungalow
- Well Presented Throughout
- Ample Storage
- Off Road Parking & Garage
- Gardens to Front & Rear
- Sought After Location
- EPC: TBC. Council Tax: C.
- No Onward Chain
- Viewing Advised

