



Meadow View, Lymm, Cheshire

Offers Over £250,000

3 1 2



Keenly priced to attract early interest, this spacious three bedroom semi-detached house offers an affordable route into a sought after address just off Whitbarrow Road, Lymm.

Features include; entrance porch & hall, lounge, dining room, kitchen, first floor landing, three good size bedrooms and bathroom. Outside there is a good size South facing garden at the rear and a useful brick built storage facility at the side.

Early Viewing Essential. No Chain Delay With This Sale.

Viewing

By prior appointment through our Stockton Heath office on 01925-398343.

Note

All measurements are approximate. No appliances or central heating systems referred to within these particulars have been tested and therefore their working order cannot be verified. Floor plans are for guide purposes only and all dimensions are approximate and are not to be used for room and furniture planning.

Agents Notes

Tenure: Freehold

Council Tax Band: C

Local Authority: Warrington Borough Council

EPC Rating: D



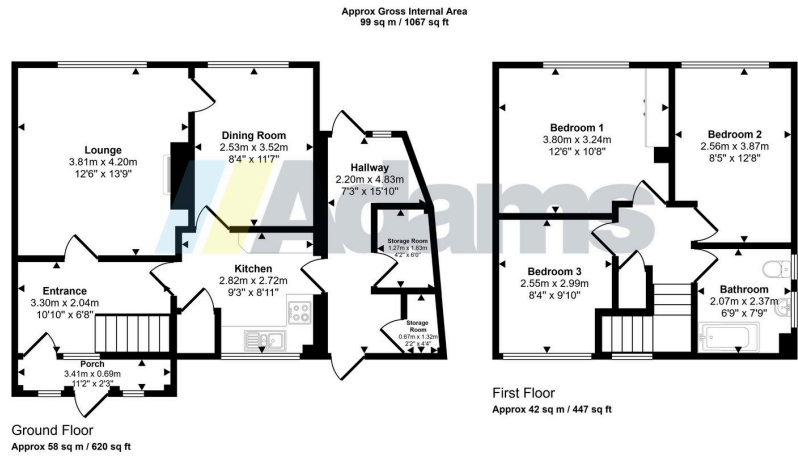

This floorplan is only for illustrative purposes and is not to scale. Measurements of rooms, doors, windows, and any items are approximate and no responsibility is taken for any error, omission or mis-statement. Icons of items such as bathroom suites are representations only and may not look like the real items. Made with Made Snappy 360.

- Spacious Semi-Detached
- Three Good Size Bedrooms
- Two Reception Rooms
- Sought After Lymm Location
- South Facing Rear Garden
- On Street Parking
- Early Viewing Advised
- No Chain Delay



Energy Efficiency Rating		
	Current	Potential
<i>Very energy efficient - lower running costs</i>		
(92 plus) A		
(81-91) B		81
(69-80) C		
(55-68) D	63	
(39-54) E		
(21-38) F		
(1-20) G		
<i>Not energy efficient - higher running costs</i>		
England & Wales	EU Directive 2002/91/EC	