



 Adams

Birchdale Road, Appleton, Warrington

£625,000

3 2 2



*****CANALSIDE LOCATION*****

Adams Estate Agents are delighted to offer for sale this substantial three bedroom detached bungalow, located within a private cul-de-sac off the highly regarded Birchdale Road.

In brief, the accommodation comprises of; entrance hall, utility, kitchen/diner, a large lounge, conservatory, three double bedrooms and a modern bathroom. Externally, the property stands well within its plot and benefits from a large rear garden with direct access onto The Bridgewater Canal and mooring rights for two boats. To the front of the property, there is a large driveway and garage.

Properties on this road rarely become available and we would advise a viewing at your earliest opportunity.

No Chain Delay With This Sale.

Viewing

By prior appointment through our Stockton Heath office on 01925-398343.

Notes

All measurements are approximate. No appliances or central heating systems referred to within these particulars have been tested and therefore their working order cannot be verified. Floor plans are for guide purposes only and all dimensions are approximate.

Agent Notes

Tenure: Freehold

Local Authority: Warrington Borough Council



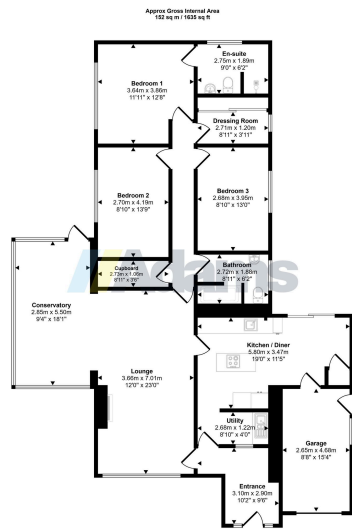

Floorplan

This floorplan is only for illustrative purposes and is not to scale. Measurements of rooms, areas, windows and any items are approximate and are responsible to owner for any errors contained in this statement. None of the items shown in this floorplan are representations only and may not look like the real items. Made with Vitae Snappy 360.

- Spacious Detached Bungalow
- Mooring For Two Boats
- Lounge & Conservatory
- Garage
- Driveway
- Sought After Canal Side Location
- Three Double Bedrooms
- Kitchen / Diner
- Large Rear Garden
- No Chain Delay

