

Ingelton Grove, Beechwood

£290,000

3 1 2



****IMMACULATE THREE BEDROOM DETACHED FAMILY HOME. EVER POPULAR BEECHWOOD AREA. NO ONWARD CHAIN****

Adams Estate Agents are delighted to offer to the sales market this three bedroom detached family home set on the ever sought after location of Beechwood. The property has been immaculately kept by its current owner and offers well equipped family sized accommodation over two floors. In brief, the accommodation comprises; entrance hall, lounge, dining room, kitchen and WC to the ground floor. To the first floor there are three bedrooms and recently fitted shower room. Externally, the property sits well within its plot boasting a driveway providing off

road parking and access to the garage. To the rear, there is an enclosed laid to lawn garden with flagged patio area. Viewing is essential to fully appreciate what is offered. EPC Rating D. Council Tax Band D. Leasehold 49 years remaining.

Key Features

- Three Bedroom
- Detached Home
- Immaculately Presented
- Sought After Area
- Viewing Advised
- EPC Rating D. Council Tax D. Leasehold Tenure 49 years remaining.
-
-

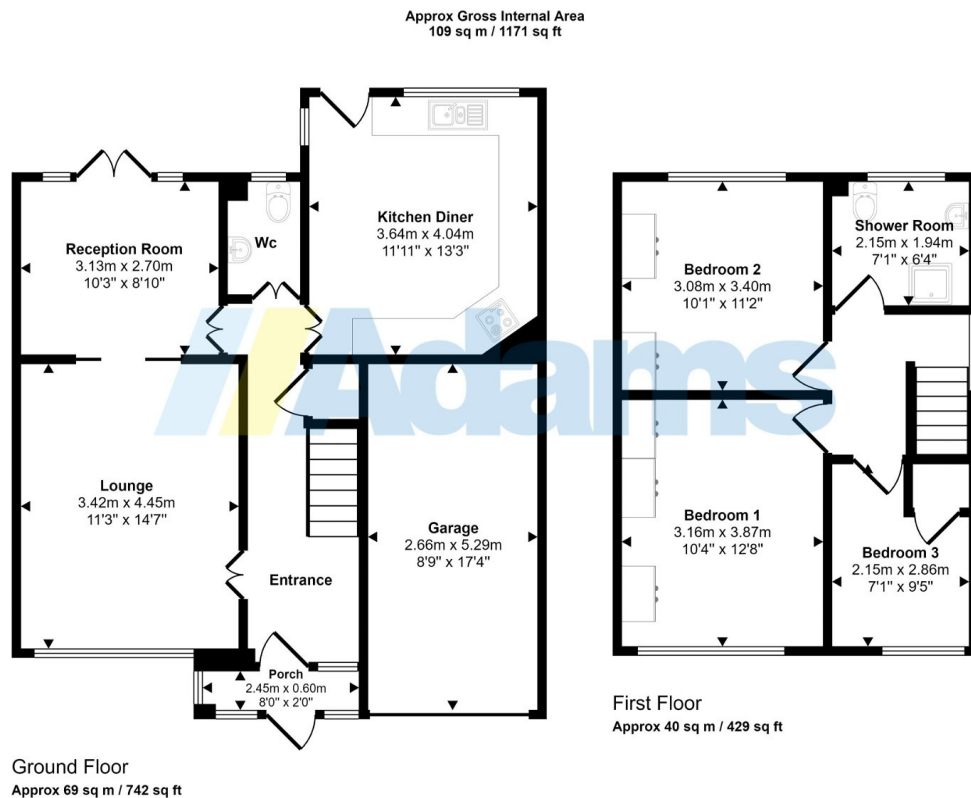

This floorplan is only for illustrative purposes and is not to scale. Measurements of rooms, doors, windows, and any items are approximate and no responsibility is taken for any error, omission or mis-statement. Icons of items such as bathroom suites are representations only and may not look like the real items. Made with Made Snappy 360.