

## 127 Wellfield Street, Warrington

£180,000

3 1 2

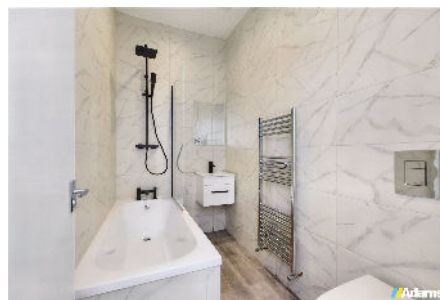

**RECENTLY REFURBISHED. THREE BEDROOM TRADITIONAL TERRACED PROPERTY.**



## Key Features

- Three Bedroom
- Recently Refurbished
- Popular & Convenient Location
- Viewing Advised
- Traditional Terraced
- Open Plan Receptions
- Enclosed Yard
- No Onward Chain

Approx Gross Internal Area  
85 sq m / 913 sq ft

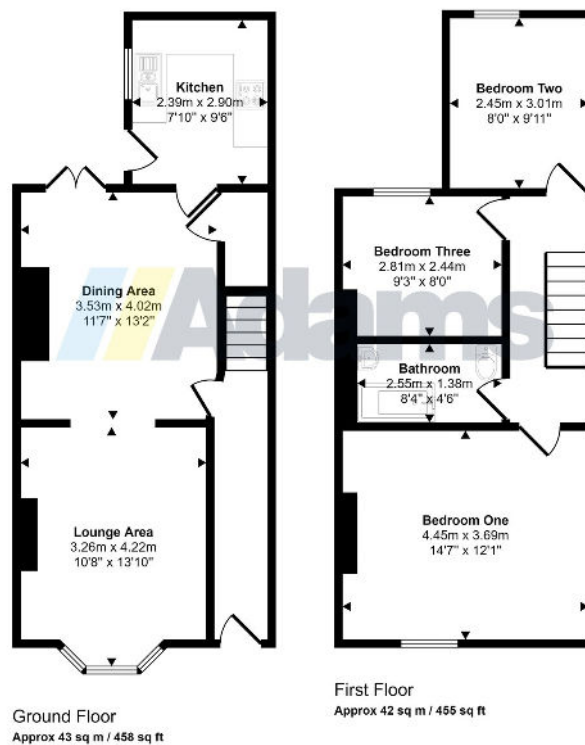

This floorplan is only for illustrative purposes and is not to scale. Measurements of rooms, doors, windows, and any items are approximate and no responsibility is taken for any error, omission or mis-statement. Icons of items such as bathroom suites are representations only and may not look like the real items. Made with Made Snappy 360.