



**Adams**  
Your local property experts

# Beech Cottages, Stretton Road, Stretton, WA4 4NR

£525,000

🛏 3 🚿 2 🛋 3



- Lovely Potton Built Detached Home
- Excellent Semi-Rural Location
- Outlook Over Fields
- Three Reception Rooms
- Home Office + Ground Floor WC
- Impressive Master Bedroom Suite
- Large Converted Loft Room
- South Facing Rear Garden
- Oversize Garage & Ample Parking



A lovely detached home occupying a prime semi-rural position with South facing gardens and an outlook over fields on Stretton Road, Stretton.

This Potton built property provides spacious, well planned accommodation comprising; a large covered entrance porch, an impressive hallway, WC, home office, sitting room, separate living room with feature inglenook fireplace and solid fuel burning stove, dining room, conservatory, kitchen, first floor landing, impressive master bedroom with vaulted ceiling, ensuite, two further bedrooms, family bathroom and a large carpeted and heated loft room.

An oversize integral single bay garage (with utility area), plus large double entrance block paved driveway provide ample parking facilities. The beautiful South facing rear garden is a particularly attractive feature with a lawn, lawn area, lawn and a garage.

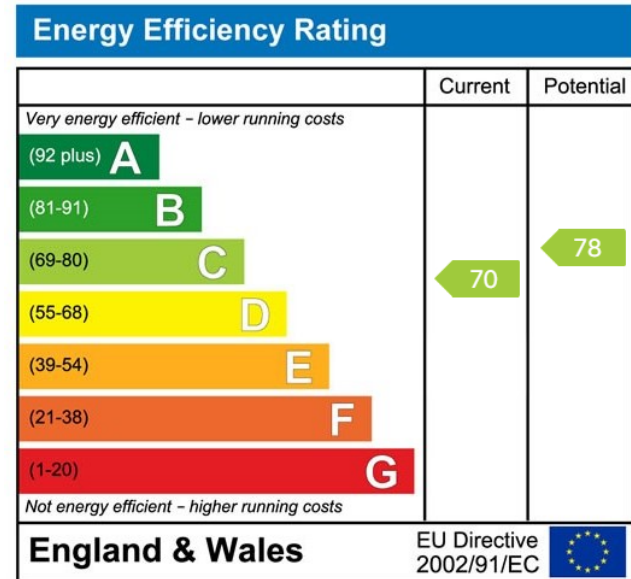
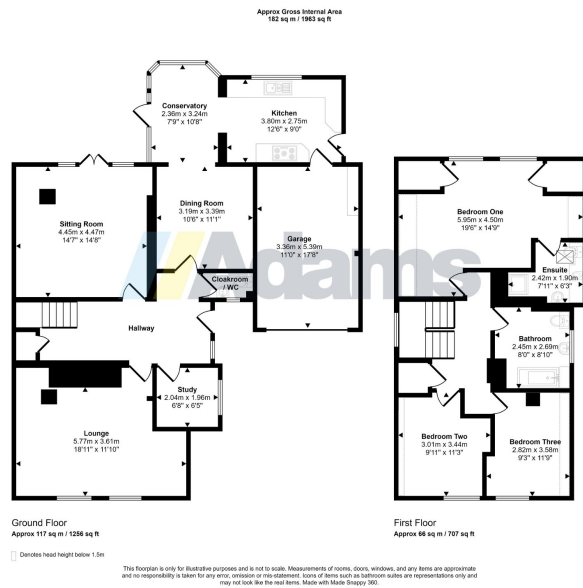

www.adamsea.co.uk

Adams is a trading name of Adams Residential Sales LLP  
Registered office 12-14 Walton Road, Stockton Heath, WA4 6NL  
VAT Registration No. 247 263 989. Partnership No. OC0403357

Stockton Heath  
12-14 Walton Road, Stockton Heath, WA4 6NL  
T: 01925 398343  
E: s.heath@adamsea.co.uk