



Wharfside Court, Appleton, Warrington

£675,000

 4  2  2



A substantial modern bungalow located in private development of just three detached properties next to the Bridgewater Canal in Appleton.

This unique property stands in a particularly generous size plot and offers flexible and adaptable accommodation within easy walking distance of Stockton Heath village centre.

Features of the high quality accommodation include; a large reception hall, 30ft open plan lounge / dining room, kitchen with integrated appliances, separate utility, four good size bedrooms, ensuite and four piece bathroom at ground floor level. A fixed spiral staircase in the hallway gives access to a huge first floor loft area which includes three very spacious rooms, one of which is currently used as a bedroom.

- Substantial Detached Bungalow
- Very Adaptable Accommodation
- Four Bedrooms + Two Bathrooms
- South Facing Rear Garden
- Walking Distance To Stockton Heath
- Small Modern Development
- Huge First Floor Loft Area
- High Quality Throughout
- Extensive Driveway Parking Area
- Viewing Essential

Approx Gross Internal Area
249 sq m / 2877 sq ft

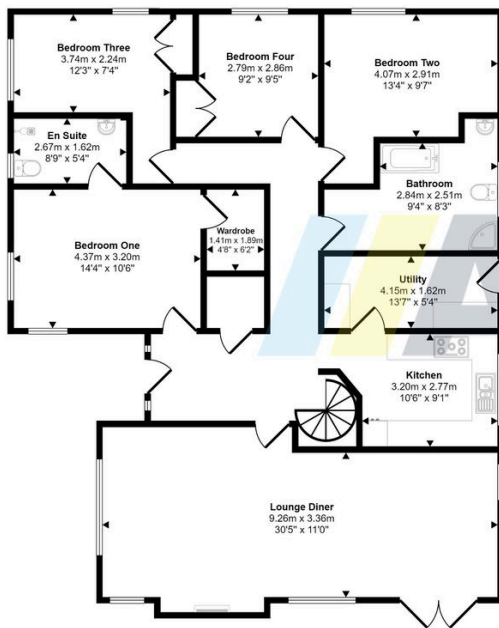

Ground Floor
Approx 141 sq m / 1521 sq ft

Denotes head height below 1.5m

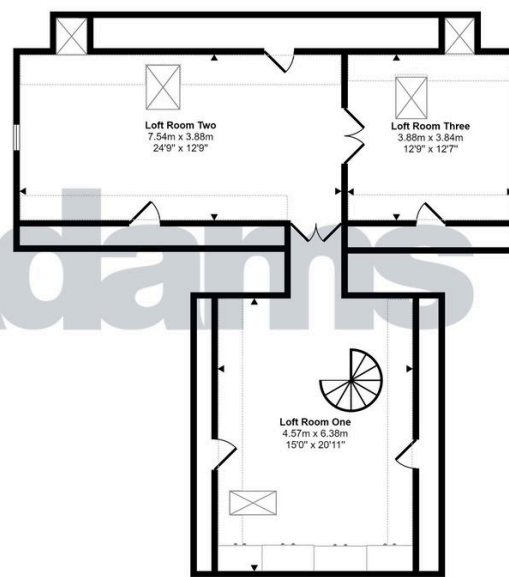

First Floor
Approx 98 sq m / 1052 sq ft

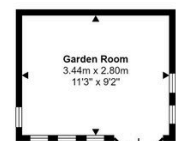

Reception Room
Approx 10 sq m / 104 sq ft

This floorplan is only for illustrative purposes and is not to scale. Measurements of rooms, doors, windows, and any items are approximate and no responsibility is taken for any error, omission or mis-statement. Icons of items such as bathroom suites are representations only and may not look like the real items. Made with Made Snappy 360.