

## Gaskell Street, Stockton Heath WA4

£250,000

🛏️ 2 🚿 1 🚗 2



**\*\*\*\*\* NO CHAIN DELAY \*\*\*\*\***

A traditional two bedroom mid terrace property offering an ideal investment or first time buyer opportunity in the centre of Stockton Heath village.

Features include; lounge, dining room, large kitchen, first floor landing, two bedrooms and bathroom. Outside there is a good sized, private, enclosed yard to the rear.

Early Viewing Advised. Ideal First Time Buy. No Chain Delay With This Sale.

- No Chain Delay
- Popular Village Centre Location
- Two Reception Rooms
- UPVC Double Glazing
- Option To Create Parking At Rear
- Traditional Mid Terrace House
- Two Double Bedrooms
- Gas Fired 'Combi' Central Heating
- Private Rear Yard

Approx Gross Internal Area  
66 sq m / 712 sq ft

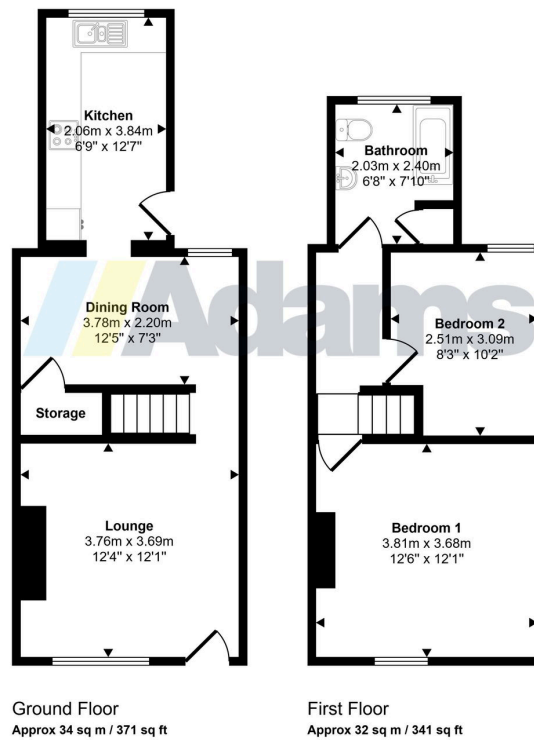

This floorplan is only for illustrative purposes and is not to scale. Measurements of rooms, doors, windows, and any items are approximate and no responsibility is taken for any error, omission or mis-statement. Icons of items such as bathroom suites are representations only and may not look like the real items. Made with Made Snappy 360.