



Rock Road, Latchford, Warrington

Offers Over £180,000

3 1 2



A beautifully presented three bedroom mid terrace house located in a very popular position on Rock Road, Latchford.

The immaculate accommodation has been comprehensively updated in recent years and briefly includes; lounge, dining room, refitted kitchen, rear vestibule, refitted bathroom, first floor landing and three good size bedrooms. Outside there is a West facing yard at the rear and on street parking available at the front.

Early Viewing Essential. Ideal First Time Buy. No Chain Delay With This Sale.

Viewing

By prior appointment through our Stockton Heath office on 01925-398343.

Note

All measurements are approximate. No appliances or central heating systems referred to within these particulars have been tested and therefore their working order cannot be verified. Floor plans are for guide purposes only and all dimensions are approximate.

Agents Notes

Tenure: Leasehold

Lease Term: TBC

Annual Ground Rent: TBC

Council Tax Band: A

Local Authority: Warrington Borough Council



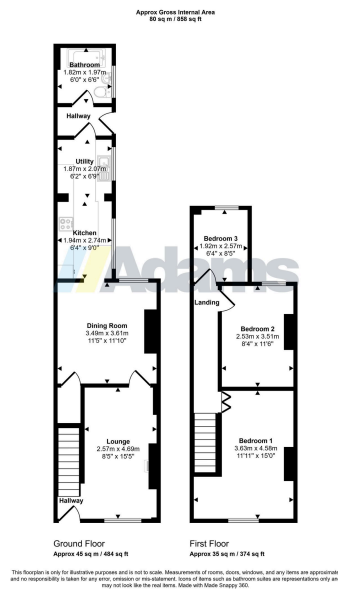

- Beautifully Presented Terrace • Popular & Convenient Location
- Three Good Size Bedrooms • Two Reception Rooms
- Refitted Kitchen & Bathroom • Immaculate Presentation
- Combi Gas C.H. & UPVC D.G. • West Facing Rear Yard
- Ideal First Time Buy • No Chain Delay

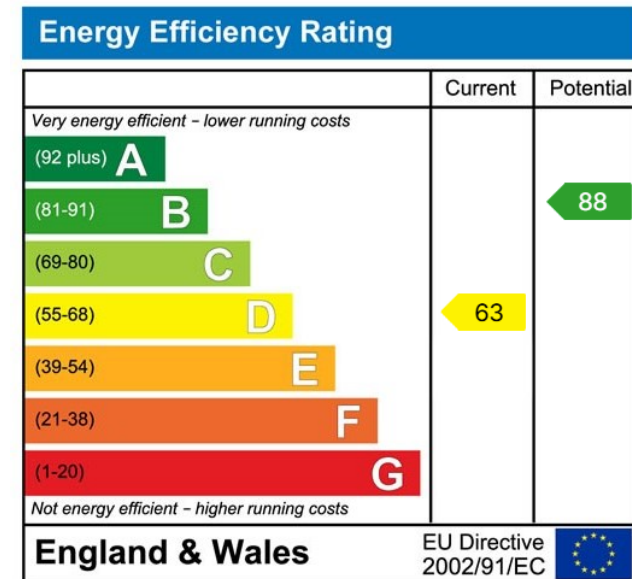

www.adamsea.co.uk

RUNCORN

54 High Street, Runcorn, WA7 1AW
01928 574401
runcorn.sales@adamsea.co.uk

STOCKTON HEATH

12-14 Walton Road, Stockton Heath, WA4 6NL
01925 398343
s.heath@adamsea.co.uk

WIDNES

53-55 Albert Road, Widnes, WA8 6JS
0151 420 4055
widnes.sales@adamsea.co.uk