

## Foxdale Court, Appleton WA4

£170,000

1 1 1

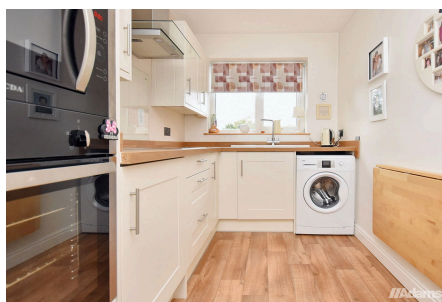
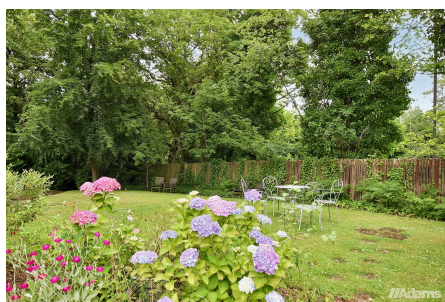

### 1-Bedroom Ground Floor Apartment with Private Garden – Over 55s Development in Appleton

A well-presented ground floor apartment located in a quiet and attractive courtyard development in the popular area of Appleton, exclusively for residents aged 55 and over.

This spacious one-bedroom property offers a peaceful and private setting, complete with its own patio, perfect for outdoor relaxation.

## Key Features

- Ground Floor Apartment
- Spacious Lounge With Dining Area
- Well-Appointed Bathroom
- Residents' Parking
- Sought-After Appleton Location
- Private Garden & Patio Area
- Generous Double Bedroom
- Over-55s Development
- Attractive Communal Gardens
- No Chain

Approx Gross Internal Area  
42 sq m / 450 sq ft

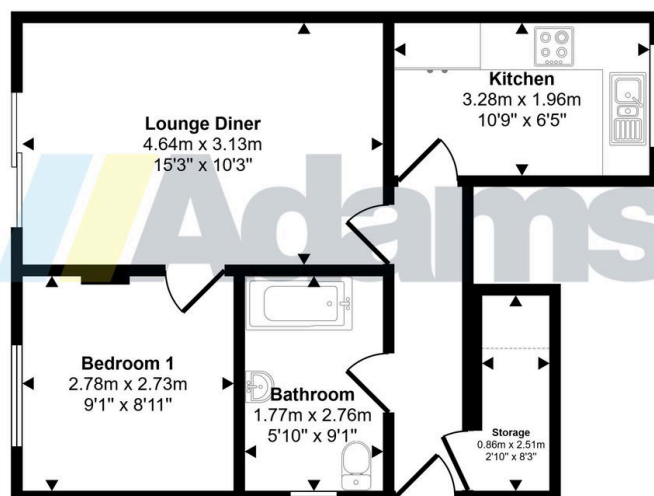

Floorplan

 Denotes head height below 1.5m

This floorplan is only for illustrative purposes and is not to scale. Measurements of rooms, doors, windows, and any items are approximate and no responsibility is taken for any error, omission or mis-statement. Icons of items such as bathroom suites are representations only and may not look like the real items. Made with Made Snappy 360.