

Astley Close, WA4 6RB

£285,000

🛏 2 🚿 1 🚗 1



This semi-detached true bungalow occupies an excellent, slightly elevated position on Astley Close and benefits from a lovely garden at the rear.

Features briefly include; gas fired central heating, UPVC double glazing, entrance hall, lounge, modern kitchen / diner, two double bedrooms and bathroom. Outside there is driveway parking for several cars and the rear garden enjoys a favourable south westerly aspect.

Early Viewing Advised. No Chain Delay With This Sale.

Key Features

- Semi Detached True Bungalow
- Excellent Elevated Position
- Popular & Convenient Location
- Two Double Bedrooms
- Modern Kitchen / Diner
- Gas C.H. & UPVC D.G.
- South West Facing Garden
- Driveway Parking
- Early Viewing Advised
- No Chain Delay

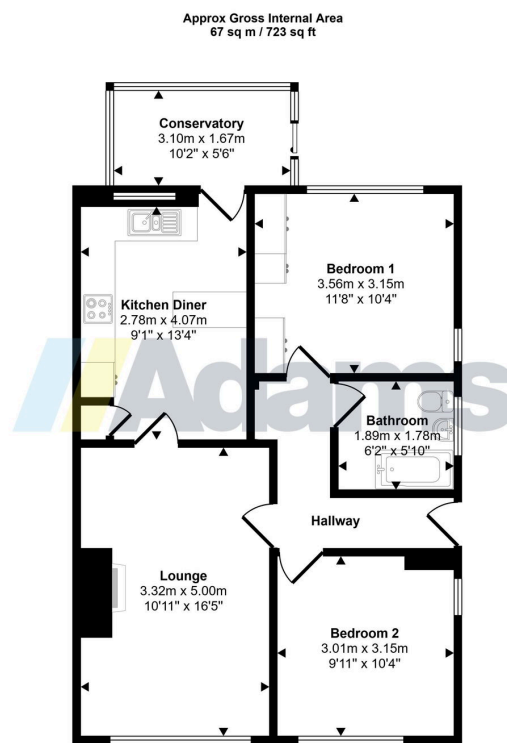

Floorplan

This floorplan is only for illustrative purposes and is not to scale. Measurements of rooms, doors, windows, and any items are approximate and no responsibility is taken for any error, omission or mis-statement. Icons of items such as bathroom suites are representations only and may not look like the real items. Made with Made Snappy 360.