



Moorfield Road, Widnes

Offers Over £210,000

 4  2  2



- Bay Fronted Terrace
- No Chain Delay
- Modern Fitted Kitchen
- Close to Amenities
- Council Tax B
- Four Bedrooms
- Two Bathrooms
- Popular Location
- Early Viewing Essential
- EPC to Follow

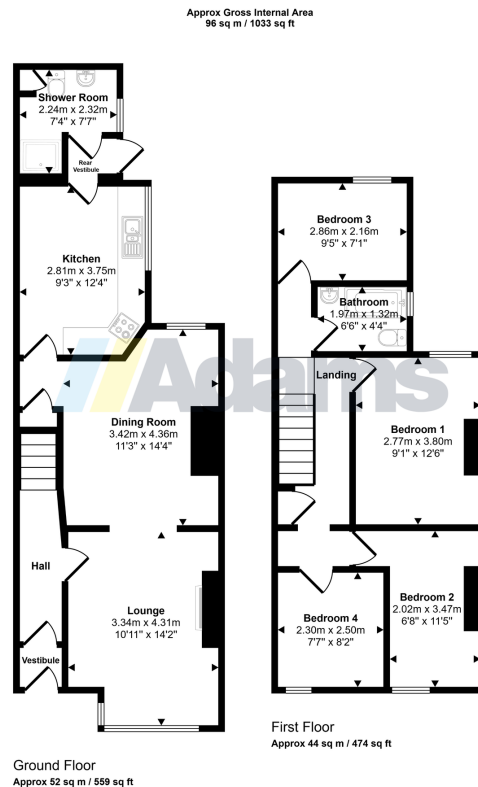

This floorplan is only for illustrative purposes and is not to scale. Measurements of rooms, doors, windows, and any items are approximate and no responsibility is taken for any error, omission or mis-statement. Icons of items such as bathroom suites are representations only and may not look like the real items. Made with Made Snappy 360.

***** Spacious Four Bedroom Period Terraced Property Offered with No Chain Delay***** Adams Real Estate are delighted to market this spacious bay fronted, terraced house located on the ever popular Moorfield Road. The property sits proudly within easy reach of excellent local schools, Widnes town centre and is offered with the advantage of no chain delay making an early perusal a must.

Features include entrance vestibule, hall, lounge, dining room, modern fitted kitchen, rear hall and shower room to the ground floor. Landing, four bedrooms and family bathroom to the first floor. Externally, gardens to front and rear. Council Tax B. EPC to Follow.