



Cliffe Road WA4 5AQ

£575,000

 4  2  3



- Four Spacious Bedrooms
- Modern Kitchen Diner
- Generous Lounge
- Downstairs W/C
- Garage
- Bright And Airy Conservatory
- Separate Dining Room
- Large Entrance Hallway
- Driveway Parking
- Well-Maintained, Large Rear Garden

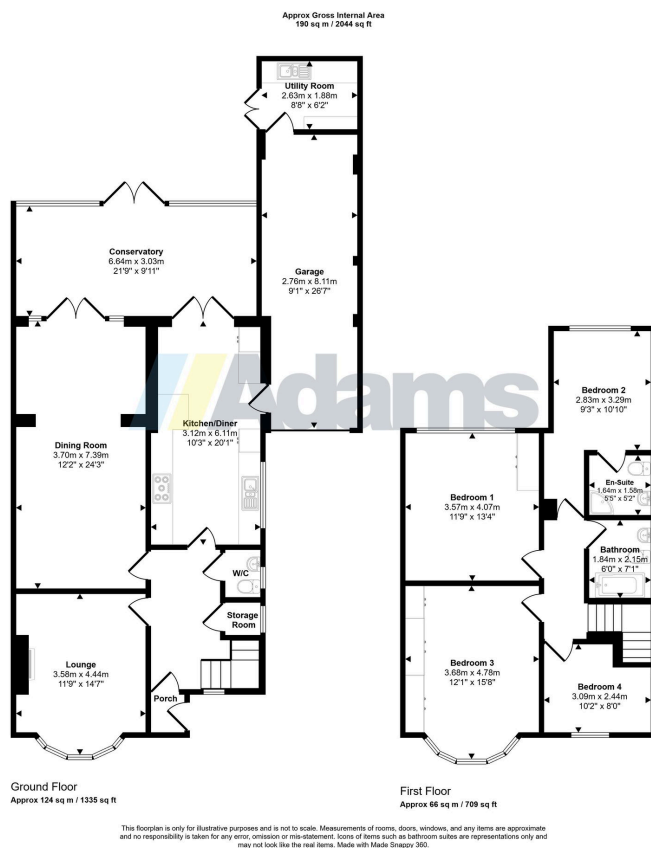

Beautiful Presented 4-Bedroom Semi-Detached Home – Sought-After Appleton Location

Located in the highly desirable area of Appleton, this spacious 4-bedroom semi-detached property offers the perfect blend of modern family living and stylish design.

Key features:

Four generous bedrooms, including one with en-suite

Bright and spacious lounge

Separate dining room and conservatory

Modern kitchen diner

Downstairs W/C

Large welcoming hallway with stunning feature window

Stylish family bathroom

Well-maintained rear garden – ideal for families and entertaining

Garage and private driveway providing off-road parking

Quiet, sought-after residential location