



Clearwater Quays WA4

£99,950

1 1 1



Top Floor 1-Bedroom Apartment in a Sought-After Location

Located within walking distance of the popular Latchford Village, this well-presented top floor apartment offers stylish and convenient living in a desirable setting.

The property features a spacious lounge with a charming Juliette balcony, providing plenty of natural light and an airy feel. The fitted kitchen offers ample storage and workspace, while the bathroom is finished to a good standard. A handy storage cupboard in the entrance hallway adds practicality.

The generous double bedroom completes the accommodation, making this an ideal home for first-time buyers, professionals, investors or those looking to downsize.

Situated in a sought-after area with local shops, cafes, and amenities nearby, and excellent transport links into Warrington and beyond, this apartment combines comfort with convenience.

Offered with no chain.

Viewing

By prior appointment through our Stockton Heath office on 01925-398343.

Agents Notes

Tenure: Leasehold

Lease Term: 250 years from 1st January 2007 (231 years remaining)

Annual Ground Rent: circa £100 per annum tbc

Service Charge: circa £800 tbc



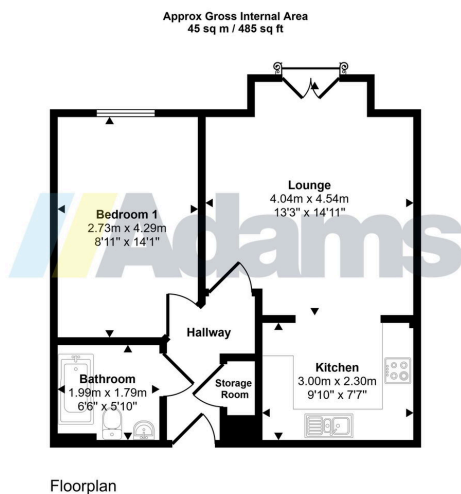

This floorplan is only for illustrative purposes and is not to scale. Measurements of rooms, doors, windows, and any items are approximate and no responsibility is taken for any error, omission or mis-statement. Icons of items such as bathroom suites are representations only and may not look like the real items. Made with Made Snappy 360.

- Top floor position
- Fitted kitchen with ample storage
- Generous double bedroom
- Light and airy accommodation throughout
- Walking distance to Latchford Village amenities
- Spacious lounge with Juliette balcony
- Spacious bathroom
- Handy storage cupboard in hallway
- Highly sought-after location
- Excellent transport links into Warrington and beyond

