



# Astley Close, Warrington, WA4 6RB

£270,000

🛏️ 2 🚿 1 🚗 2



- Two Bedroom
- True Bungalow
- Off Road Parking & Garage
- Popular Cul-De-Sac
- Semi-Detached
- Spacious Throughout
- Enclosed Garden
- Viewing Advised



A spacious semi-detached bungalow occupying a favourable position within the popular residential area of Astley Close.

We are delighted to offer for sale this well-presented two-bedroom semi-detached bungalow, benefiting from off-road parking, a garage with newly fitted door, and an enclosed low-maintenance hard landscaped garden.

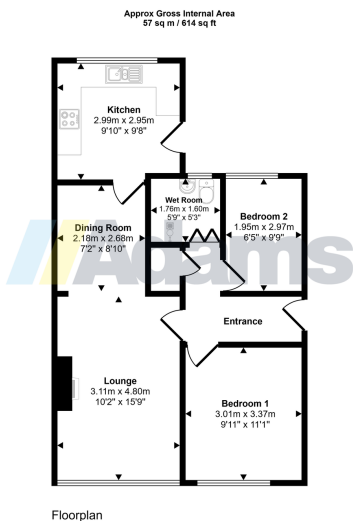

This floorplan is only for illustrative purposes and is not to scale. Measurements of rooms, doors, windows, and any items are approximate and no responsibility is taken for any error, omission or mis-statement. Icons of items such as bathroom suites are representations only and may not look like the real items. Made with Made Snappy 360.

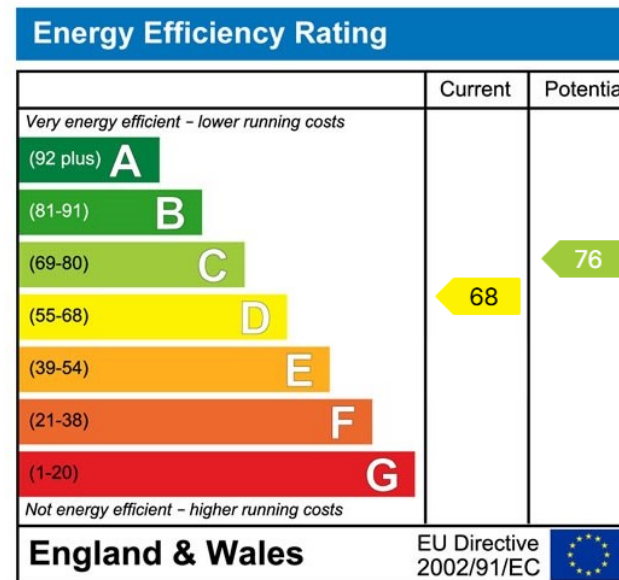

[www.adamsea.co.uk](http://www.adamsea.co.uk)

**RUNCORN**

54 High Street, Runcorn, WA7 1AW  
01928 574401  
runcorn.sales@adamsea.co.uk

**STOCKTON HEATH**

12-14 Walton Road, Stockton Heath, WA4 6NL  
01925 398343  
s.heath@adamsea.co.uk

**WIDNES**

53-55 Albert Road, Widnes, WA8 6JS  
0151 420 4055  
widnes.sales@adamsea.co.uk

Adams is a trading name of Adams Sales Ltd.  
Registered office 53 Albert Road, Widnes, WA8 6JS.  
VAT Registration No. 582 2476 27. Registered in England No. 05232172